



39 Birch House Leigh Street, High Wycombe, Buckinghamshire, HP11 2WR

£1,050 Per month





## 39 Birch House Leigh Street, High Wycombe, Buckinghamshire, HP11 2WR

**£1,050 Per month**

New to the market, this impressive first floor unfurnished modern one bedroom executive apartment is located in the popular Birch House development, just off Leigh Street in High Wycombe.

The property itself benefits from a long hallway with storage cupboard leading to an open plan living area with wooden flooring and large windows offering plenty of natural light, a stylish white kitchen with integrated appliances, double bedroom, luxury shower room, neutral decoration throughout and a Viewsecure intercom service.

Birch House is located close to High Wycombe centre and the mainline railway station, with the M40 just a few minutes drive away.

\* Sorry no allocated parking with this property. \*



## Description



## Situation



Unfurnished

Council Tax Band: B

Available: 29th November 2025

Floor Plans

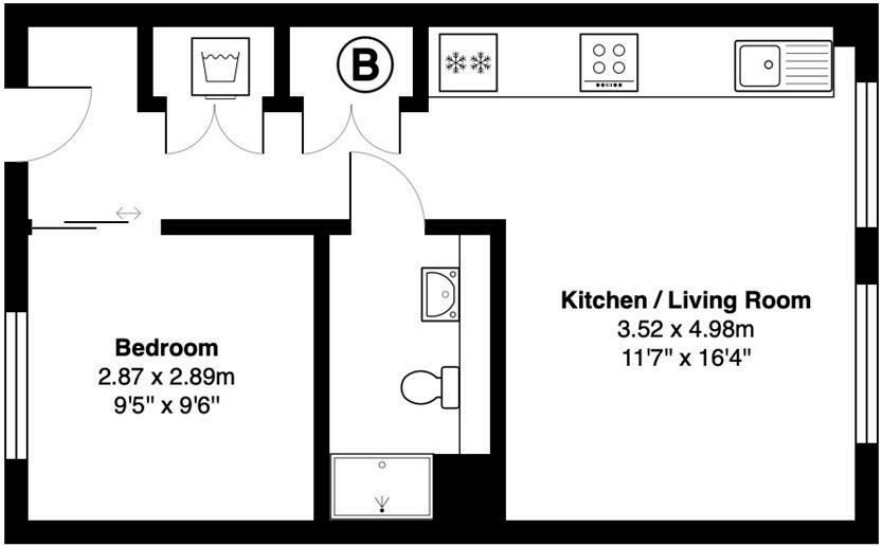

All measurements are approximate and for display purposes only

Area Map

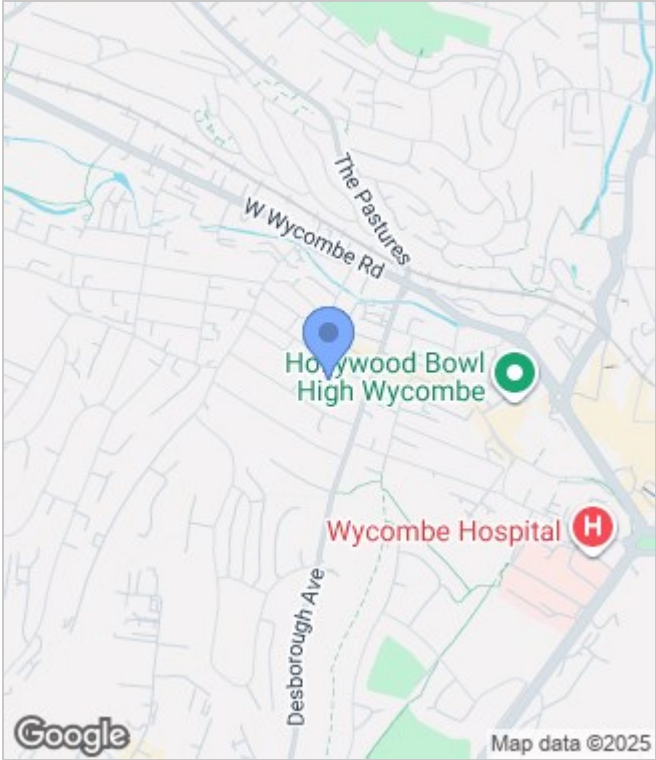

Energy Performance Graph

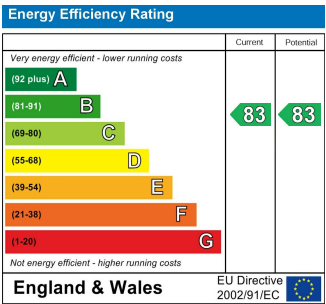

These particulars, whilst believed to be accurate are set out as a general outline only for guidance and do not constitute any part of an offer or contract. Intending purchasers should not rely on them as statements of representation of fact, but must satisfy themselves by inspection or otherwise as to their accuracy. No person in this firms employment has the authority to make or give any representation or warranty in respect of the property.